



WC UNIVERSAL FRAME

Specifically designed for wall hung pans sited on a flat wall or in a corner and can be used within furniture.

INSTALLATION INSTRUCTIONS

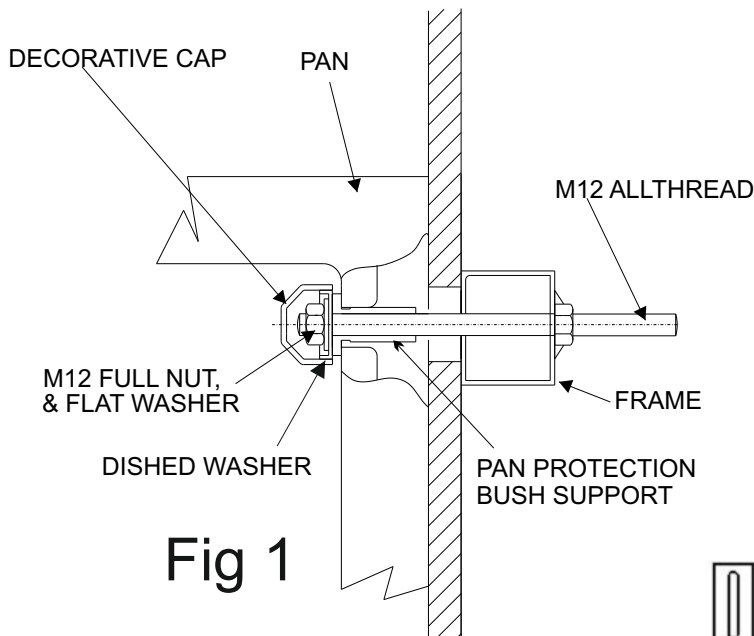
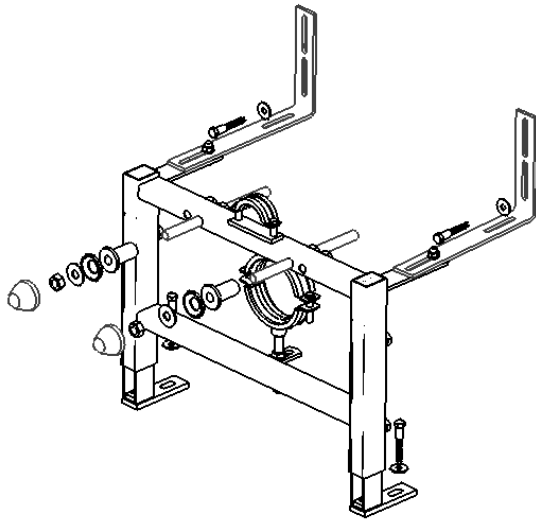

Fig 1

1. Set frame height .

To adjust height of frame slacken off bolts holding adjustable legs in frame. Adjust the position of the legs so that the WC pan rim is 400mm above the floor level. Re-tighten the bolts clamping the legs into position. The feet can be rotated, into any position to suit installation, by using the screw at the foot of the leg.

2. Fit wall straps.

The wall straps are packed separately and can be used in any orientation dependant on the depth of installation required. Minimum depth is 200mm, maximum depth is 330mm. Attach firmly to frame using the M8 bolts, nuts and washers provided.

3. Fixing to wall and floor.

Attach frame securely to wall and floor using the plugs, washers and hex head screws provided. See diagrams overleaf for corner fitting. It is the responsibility of the installer to ensure that these fixings in the wall and floor are strong enough to adequately support the load which will be applied to the pan in use.

4. Fitting soil pipe.

Adjust the soil pipe clamp position to suit the pan being fitted. When in the correct position, complete plumbing of soil pipe.

5. Fitting pan.

Ensure M12 allthread protrudes sufficiently for correct and secure installation of the pan. See fig. 1 for installation detail.

Fig 2

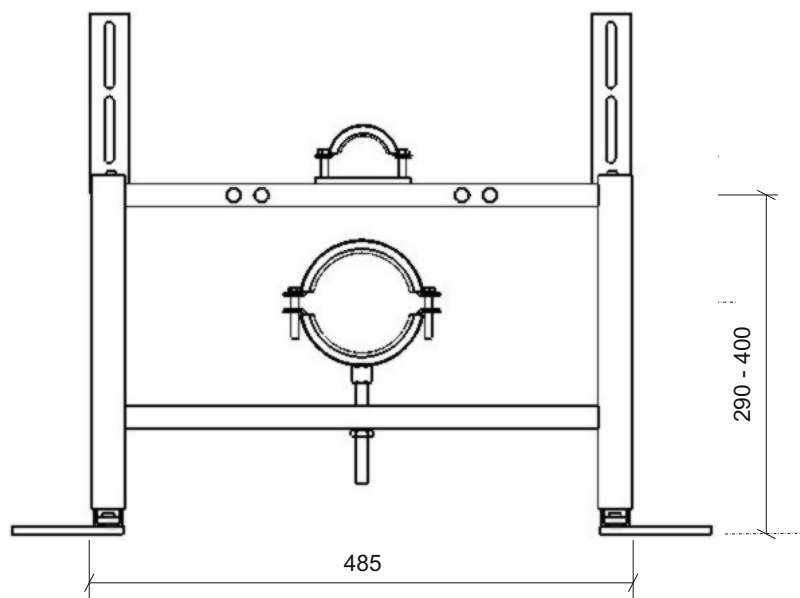

Built-in System
in Furniture

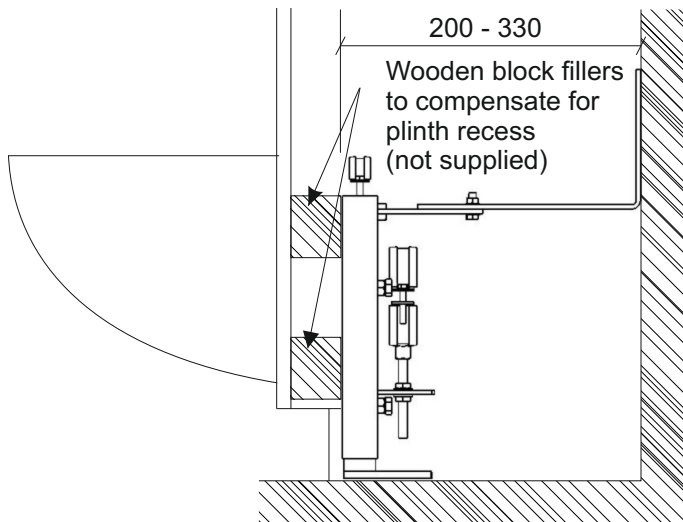

Built-in System
with dry wall

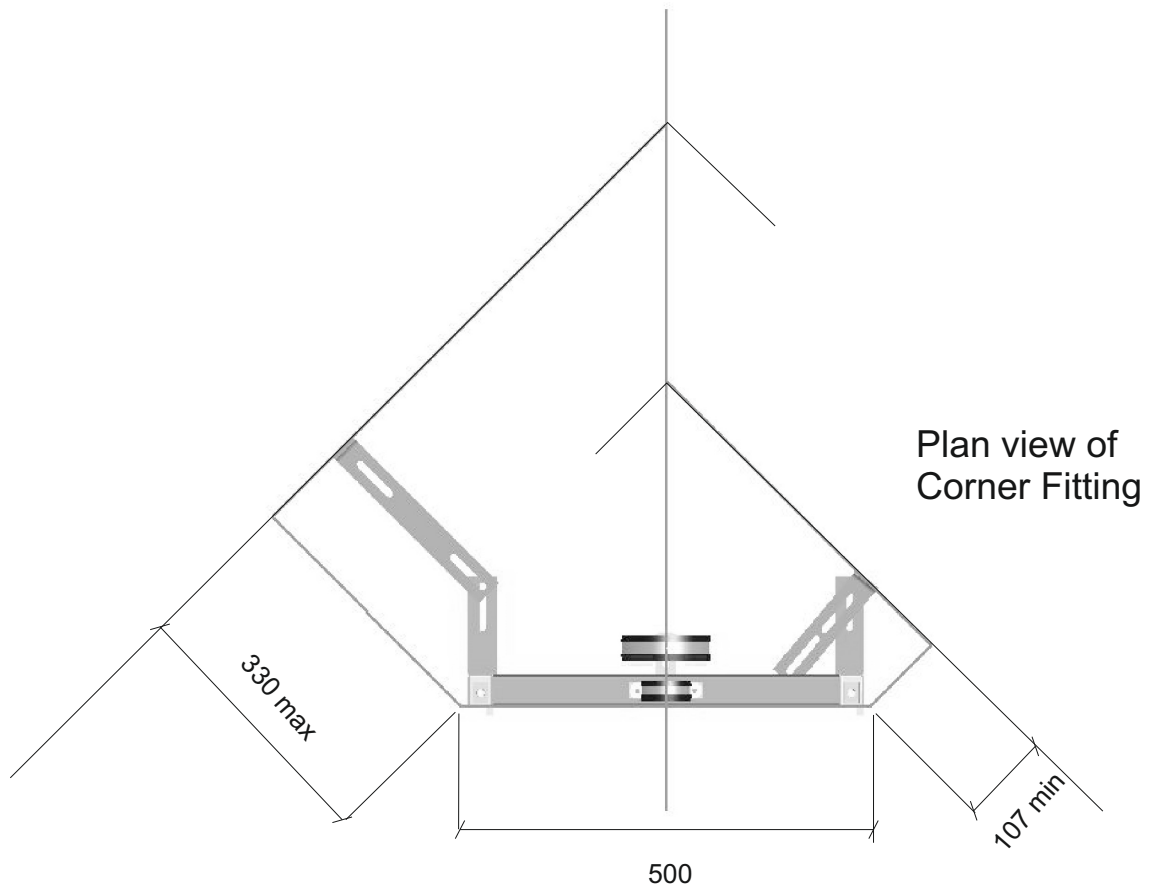
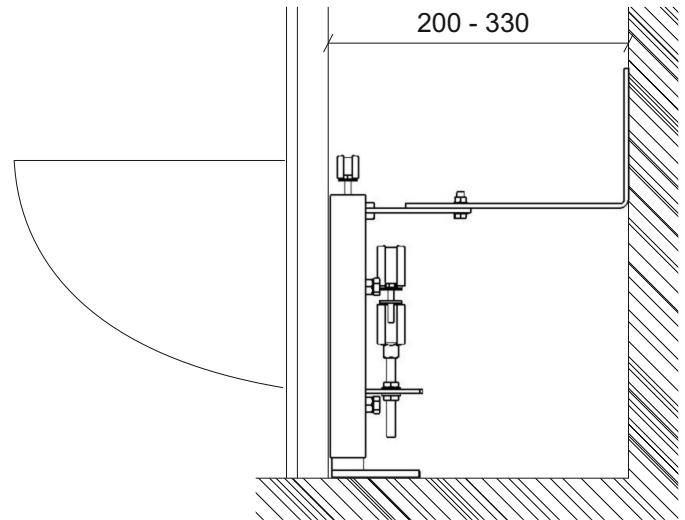

Thomas Dudley Ltd
PLASTIC CISTERN MANUFACTURERS

Dauntless Works, P.O.Box 28, Birmingham New Road, Dudley,
West Midlands, DY1 4SN

Telephone: 0121 530 7000 Fax: 0121 557 5345 E-mail: sales@thomasdudley.co.uk

PISLF510 (Tdcf 1225)