

White floor mounted stair rail



Product details

Warranty:	2 years
Max rated load:	100 kg
Doc M compliant:	No
Suitable for wet areas:	No

Features

- Robust steel construction
- Optional two or three flange design
- Durable epoxy polyester coating

Finish options

WH

White
RAL 9016

Product description

Two flange stair rail, 875mm, white (RAL 9016)
Three flange stair rail, 875mm, white (RAL 9016)

Product code

111701/WH
111702/WH

Disclaimer

NYMAS Group makes every effort to ensure that the information provided on this data sheet is correct. However, we cannot guarantee this, and accept no liability for any information or advice given on this data sheet.

Dimensions (mm)

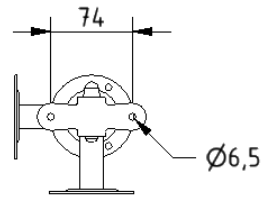

PRODUCT CODE	111701/**	111702/**
DIM 'A'	80	50

* NOTE DASHED GRAY LINE INDICATES 111702/**

